

INSTRUCTIONS | TIME SWITCH - MAXIREX D1

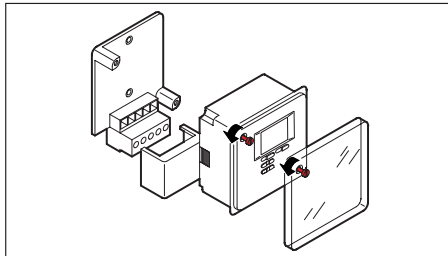

Technical data

	94 42 07	
Supply voltage:	230V 50/60Hz	
Consumption:	ca. 0,6W	
Contact rating:	changeover contact 16A 250V~μ cos φ = 1	
Parallel compensation:	60VA max. 7μF	
Accuracy:	±2,5s/d	
Terminal capacity:	single strand	multi strand
	1,5 to 4 mm ²	1 to 2,5 mm ²
Program pictures:	8	
Battery reserve:	100h	
Storage ambient:	-10°C to +60°C	
Working ambient:	-10°C to +55°C	

Connection

For safety, when the time switch is connected to the mains supply the contact should not be used on an isolated low voltage supply. When the time switch is connected to the isolated voltage supply the contact should not be used on the mains supply.

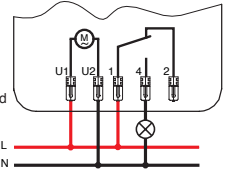

1200W	1200W	2300W	1800W	1800W	1800W

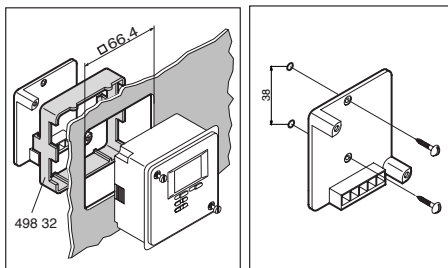

Safety notes

- Installation of these products should only be undertaken by a qualified electrician.
- The operational and electrical safety is only guaranteed, if the product is installed using its proper accessories, in a position as specified in the installation instructions.
- Any interference with the product makes the guarantee void.
- If the time switch is mounted near heat producing equipment whereby the ambient temperature of the time switch is increased to more than 55°C, a space has to be provided between the heat producing equipment and the time switch.

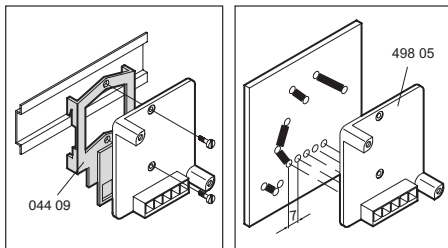

Function

The MaxiRex D1 is a microprocessor controlled digital time switch. Eight programs of your choice can be stored and used to control the automatic operation of your electrical equipment. Each individual weekday can have a separate program or you can have several days operating on the same „Block“ program. To program the MaxiRex D1 a „picture“ is used and when this is complete the chosen times are stored in the microprocessor memory. The summer-/winter changeover can be programmed for hand or automatic operation.

Presentation

Liquid Crystal Display

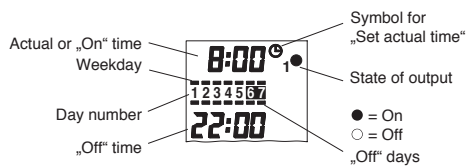

Programming Buttons

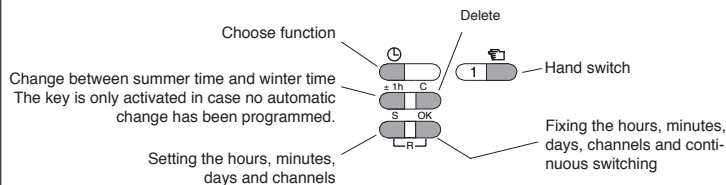

1. Starting

Before any operations the complete memory must be reset.

2. Memory reset

+ press both at the same time



The time switch memory is completely clear.

3. Setting date and summer- / winter changeover

This can only be done after a Reset.

Summer- / winter changeover can be made manually or automatically if set. If manual changeover is required choose **no** during the date input. Automatic changeover depends on your country / area. Choose the appropriate setting for your country / area.



World leader in aquatic play solutions with over 6,000 installations worldwide
 vortex-intl.com • info@vortex-intl.com
 1.877.586.7839 (free USA/CND) • +1.514.694.3868 (Intl.)

INSTRUCTIONS | TIME SWITCH - MAXIREX D1

Code d

(S) Press until the correct day is set → d:--

(OK) Press once → d:30

(S) Press until the correct month is set → -:--

(OK) Press once → d:30

(S) Press until the correct year is set → 3:--

(OK) Press once → d:E

(S) Choose (See table below)

Choice	Summer begins	Summer ends	Country / area
E	last Sunday in march	last Sunday in October	EU
A	1 st Sunday in April	last Sunday in October	only North America
Gb	last Sunday in April	4th Sunday in October	GB
no	No changeover	No changeover	

H Enter here the date for the beginning of summer for your country / area as well as the end of summertime. E.g. 31st March is shown for the beginning of Summertime. In the following years it starts on the same day irrespective of the date.

Setting of the beginning of summer code 1

(S) Set the day → 1:--

(OK) Press once → -:--

(S) Set the month → 1:31

(OK) Press once → -:--

(S) Set the year → 1:31

(OK) Press once → 3:--

The start date is set.

End date setting code 0

Set the end date as above → 0:--

(OK) Press once → -:--

After setting the summer start now set the actual time

Press (S) until display is as shown → 0:00

(OK) Press once → 1234567

4. Setting actual time

(OK) Press once → 0:00

(S) Press until the correct hour is shown → 1234567

(OK) Press once

(S) Press until the correct minute is shown → 15:32

(OK) Press once → 1234567

The weekday will shown automatically

Actual time is now set

5. Setting switching time

Each program has an On- and Off-time.

5.1 7 Day block program. Each day the same

(OK) Press until this display appears → --:--

(S) Set the On hour → 1234567

(OK) Press once

(S) Set the On minutes → 15:32

(OK) Press once → 1234567

(S) Set the Off hour → 8:00

(OK) Press once → 1234567

(S) Set the Off minutes → 22:00

(OK) Press once → 15:32

(OK) Press once → 15:32

End of program

5.2 5 Day Monday to Friday program

(OK) Press until this display appears → --:--

Set times as 5.1 above → 1234567

5.3 Single day programs

(OK) Press until this display appears → --:--

(S) Set On hour → 1234567

(OK) Press once

(S) Set On minute → --:--

(OK) Press once

(S) Set On day → --:--

(OK) Press once

(S) Set other days as required only if it is necessary

(OK) Press once

(OK) Press to change to off hour

(S) Set off hour

(OK) Press once

(S) Set off minute

(OK) Press once

(OK) If the clock is on the correct day press

Otherwise use (S) (OK) to set another day

(OK) Press once → 8:00

End of program → 22:00

End of program

6. Check switching times

(OK) Press once → 15:32

1234567

(OK) Press several times until correct "picture" is shown → 8:00

1234567

(OK) Press until the actual time is shown → 15:32

1234567

END

7. Delete switching times

(OK) Press several times until correct "picture" is shown

(C) Press to delete program and set a new programm or-

(OK) Press until the actual time is shown → 15:32

1234567

8. On and Off manual operation

(OK) Press as required

Display 1 ● = On

Display 1 ○ = Off

The time switch will follow the next „On“ or „Off“ program

9. Continuous switching

The switch condition must first be chosen

(OK) Press as required

Display 1 ● = On or 1 ○ = Off

(OK) Press once to either

Display 1 ●

Display 1 ○

The time switch will remain in continuous „On“ or „Off“ position until it is changed.

9.1 Terminating continuous switching

(OK) Press once

The time switch returns immediately to program mode

10. Continuous switching for a chosen number of days

The switch condition must first be chosen

(OK) Press to give desired function

Display 1 ● = On

Display 1 ○ = Off

(S) Press → d 1

(S) Press to choose the number of days (d1 to d99)

(OK) Press once → 15:32

1234567

END

In the above example the time switch stays „On“ for 14 days. At 0:00 hours on the 15th day the time switch returns to its program mode.

10.1 Terminating continuous switching

(OK) Press once → 15:32

1234567

11. Summer-/ Winter changeover

This function is only available if no was chosen during date input for summer-/ winter selection (see 3)

(TH) Press until the actual time goes forward 1 hour (summer) or back 1 hour (winter)

12. Correcting mistakes (only in the mode of programming)

(OK) Press once

(OK) Press until actual time is displayed → 15:32

1234567

END

13. Checking the date setting

This function is not available if no was chosen during date input for summer-/ winter selection (see 3)

(OK) + (OK) Hold & Press both buttons together → d:30

3:97

END

